

Angle Brace

A fast, effective brace for timber frames

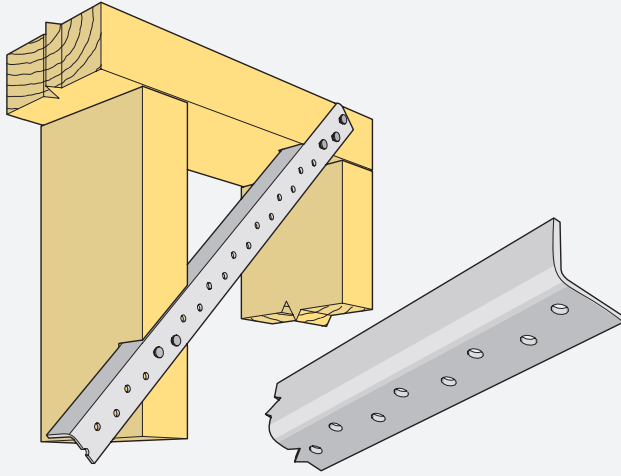

Features

Pryda Angle Brace is the fast effective way to brace interior or exterior timber framing. It is fitted by making a single saw cut into the studs, inserting the brace, then nailing.

Because Pryda Angle Brace is power punched, it features clean, fully punched holes (no nails are bent or wasted by trying to force them through the brace).

Pryda Angle Brace utilises the tension and compression strength of steel with the properties of timber. It holds studs straighter, allows better air circulation and makes it easier to install wiring, plumbing and insulation.

"Checking in" Pryda Angle Brace flush with the surface of the timber can be done easily with the Pryda Angle Brace Checka fitted to an ordinary power saw. This attachment makes the saw cut and removes the timber to "check in" the brace in one operation.

Installation

After squaring up wall or temporary frame ready for bracing:-

1. Use the edge of the steel brace to draw a straight line where the brace is to go.
2. Cut the studs 20mm deep on this line with either a Pryda Angle Brace Checka, power saw or a hand saw.
3. Slide plain leaf of the angle into the sawcut. For safety reasons the punched leaf of the angle must point downwards. Nail punched leaf to the stud through the holes provided using 30 x 3.15 Pryda Product Nails, two per stud and minimum of three per end.
4. Brace is to be 150mm minimum from end of plate.

Design Loads

Steel: Characteristic Strength = 12.5 kN (Capacity) Design Load (LSD) = 10.0 kN			Note: These steel tensile loads cannot be achieved through normal nailing in 1 leg of the angle.		
Tension: Nails in one leg only			Compression: Studs @ 600mm centres		
Number of nails each end	Characteristic Strength	Design Load (LSD) Brief	Clear Brace Length Characteristic Buckling Load Design Load Bracing Units	Brace at 45°	Brace at 55°
3	4.7 kN	3.7 kN		780mm	980mm
4	6.2 kN	5.0 kN		4.6 kN	3.1 kN
				3.7 kN	2.5 kN
				60 BU	40 BU

Applications

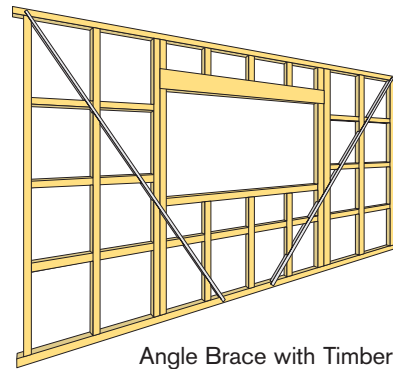

Angle Brace with Timber Nogging

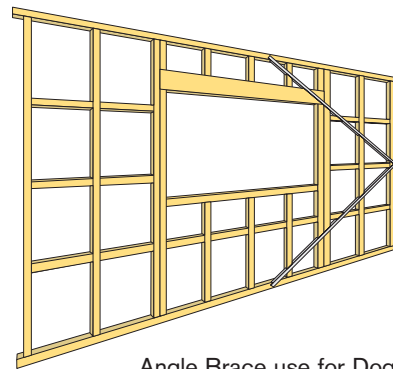

Angle Brace use for Dog-Leg Bracing

Specifications

Size:

20 X 20 X 1.00mm

Material:

G250 Z275 galvanised steel coil.

Product Code:

AB30, AB33, AB36, AB42, AB48.

Stock Lengths:

3.0, 3.3, 3.6, 4.2 and 4.8. Special lengths to order

Packing:

Bundles of 10 lengths